



9-168/5



2-50/28

2-50/15

2-5

2-50/26

2-48/17

2-50/25

2-48/9

142106 20002 Dawidy Bankowe

2-48/16

2-48/8

2-48/7

2-50/24

2-48/15

48/6

2-48/14

2-51/18

2-50/23

2-48/5

2-48/13

$L = 454m$

2-50/22 2-50/21

2-48/12

18/4

Skala 1:1000

2-50/19

2-48/11

2-48/10

jest plan zagosp

2-50/13



2-51/17

Spis 2. ul. wodogrzm.

2-50/11

Spis 2. ul. wodogrzm.

2-51/16

50/12

2-51/15

WODOCIAG FALCZYŃ NADLE

ZAD.3

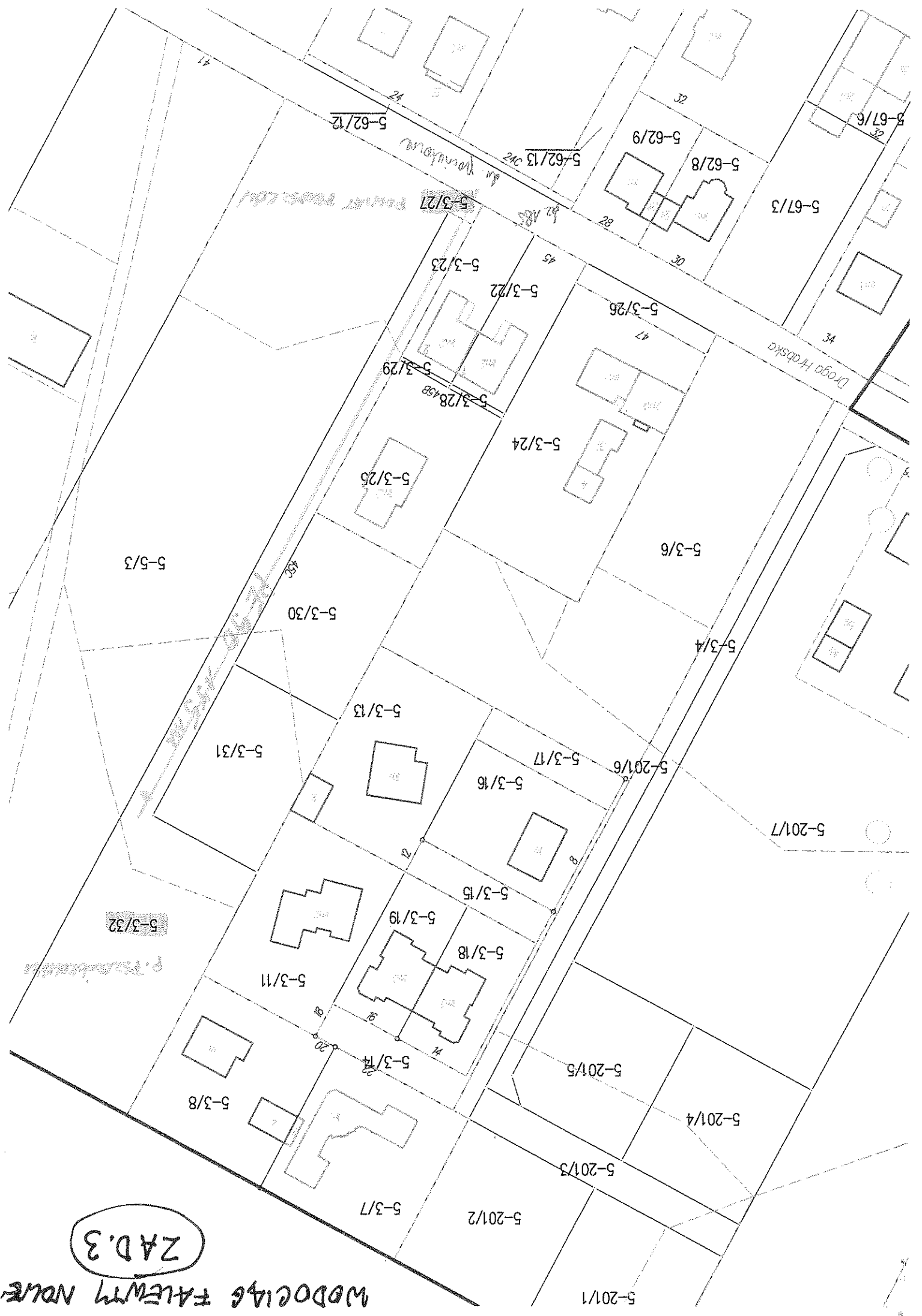

ZAD 10



5-30/1

5-31/11

5-31/12

5-31/16

5-31/17

5-31/18

5-31/19

5-31/13

5-31/14

5-31/20

5-31/23

5-31/21

5-31/15

5-31/22

5-184/3

5-30/2

5-29/2

5-184/6

SKALA 1:1000

Zbiornik

UL. JAWOROWSKA

DO HRABSKIEJ DRÓGI

ZAD 6.





7-484/1

7-483/5

7-481/8

7-484/23

7-480/11

7-484/30

7-475

7-474

7-483/4

7-481/5

7-480/10

7-473

7-480/5

7-472

7-468/9

7-480/8

7-471/4

7-468/8

7-465

7-480/2

7-471/1 7-471/3

7-468/6

7-470/2

7-470/1

7-468/4

7-468/5

7-553

7-480/1

7-469/2

7-469/1

7-468/3

7-467/2

7-462

UL. WARSZAWSKA

7-34/7

7-459

7-461

7-458

7-456

7-464

7-31

7-454/2

7-34

ZAD. 9.

КАНАЛЫЗАЦИЯ  
ИМУЩЕСТВА  
Г. БОСНИИ

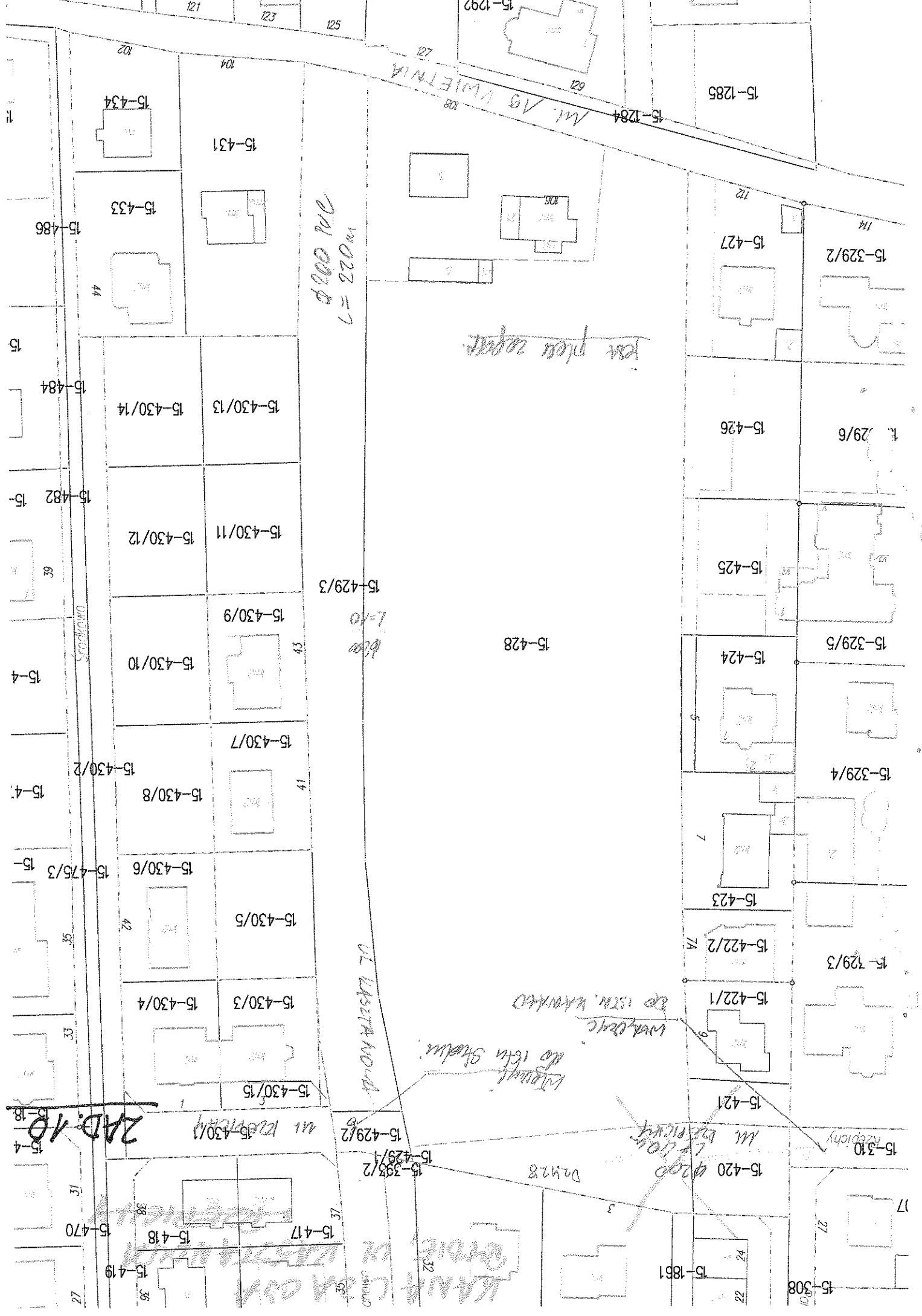

UL VAG VIMETINA

022 = 1  
000 PUL

pat přes zábratí

UL WASTRANOVA

UL VAG VIMETINA  
L-10  
L-10

ZAD. 10

UL VAG VIMETINA

UL VAG VIMETINA  
L-10  
L-10

UL VAG VIMETINA

UL VAG VIMETINA

UL VAG VIMETINA

UL VAG VIMETINA

UL VAG VIMETINA